

Plans for Jurong Lake Gardens Central and East

Event Lawn

Facing the lake, the lawn can cater for up to 7,000 visitors and can be used for community events and festivals.



Edible Show Garden

Showcases unique fruits and vegetables in landscape displays. A restaurant will serve produce from the garden.



Moon Lantern Terrace

The terrace features pavilions with lights that change shapes according to the phases of the moon.

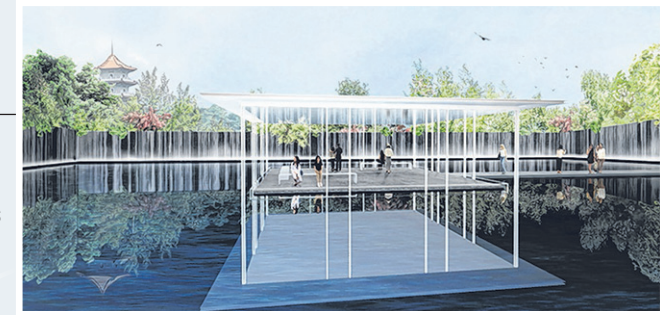
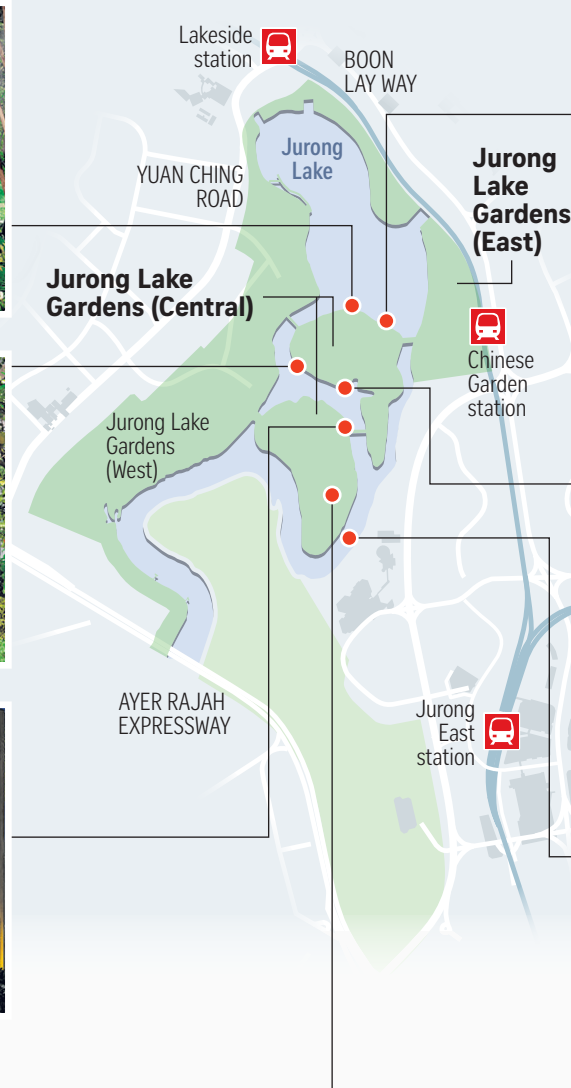
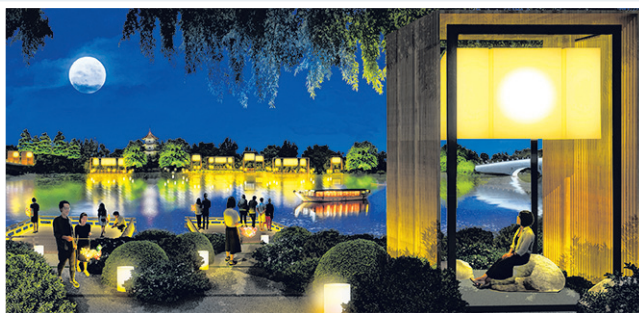

Water Wall Court

Features a 3m waterfall that creates a cool environment and aerates the water of Jurong Lake.

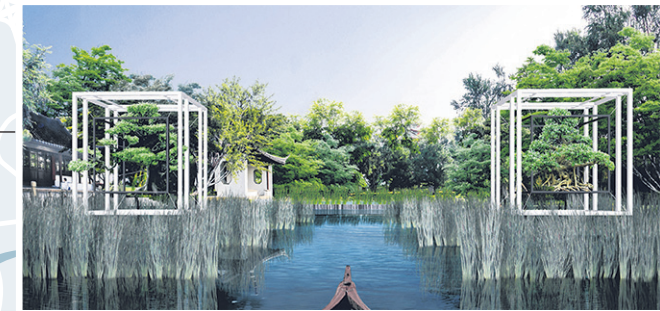

Hanging Bonsai Gate

Displays tropical bonsai plants that appear suspended in mid-air.



Water Gallery Trail

Allows leisure boaters to discover outdoor spaces featuring art and plants.

Aquatic Gardens

Features a diversity of aquatic plants, including water lilies and lotuses.

