

What are claddings?

Claddings are composite panels that are usually attached directly to the frame of a building to act as an outer wall. The Singapore Civil Defence Force (SCDF) mandates stringent fire safety standards for composite panels used on buildings.

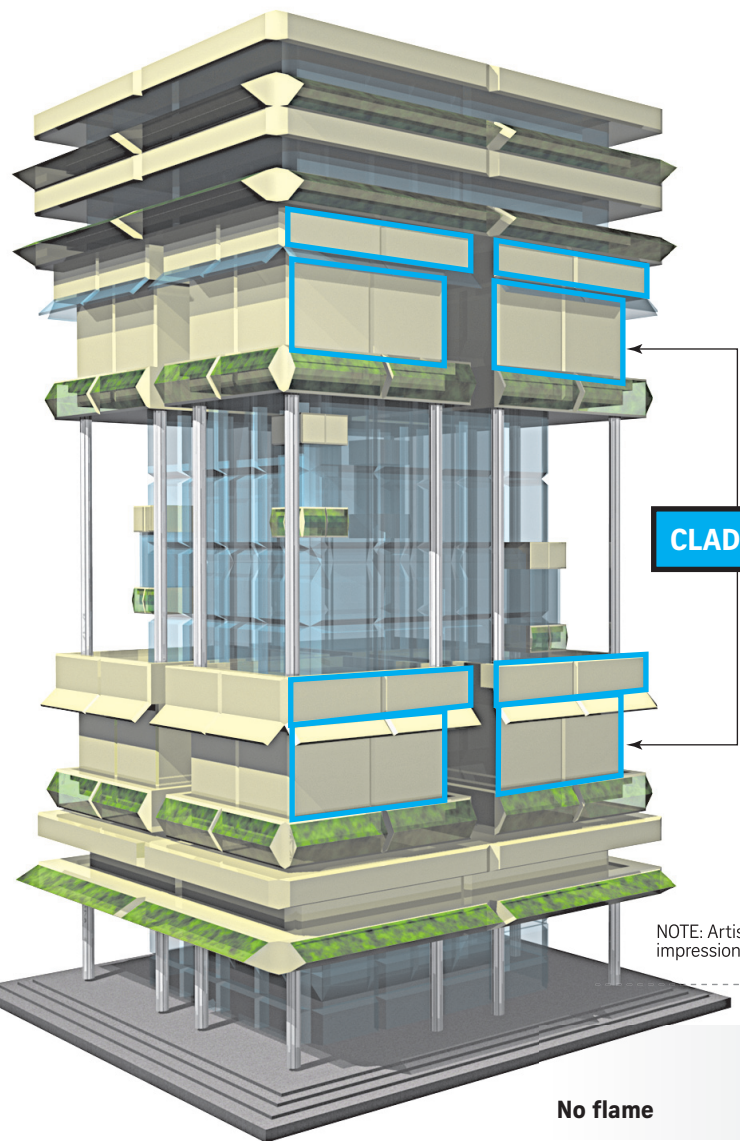

WHAT IS A COMPOSITE PANEL

A composite panel is a regulated material with a core sandwiched between two non-combustible layers

NON-COMBUSTIBLE PANELS

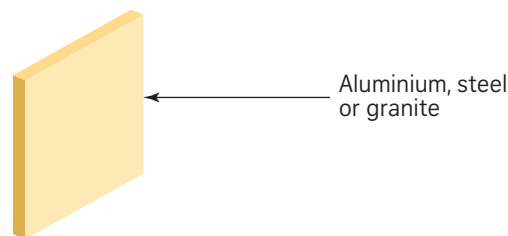

COMBUSTIBLE PANELS

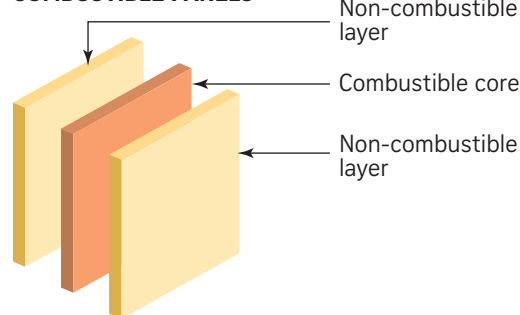

USES OF COMPOSITE PANELS

- Used on external walls as cladding
- Used as roof covering and on internal walls

CLASSIFICATION OF COMPOSITE PANELS

Under the SCDF Fire Code, panels that are not rated **Class 0** are not permitted to be used as cladding. There are five classes of composite panels. Higher classes mean that flames spread more rapidly.

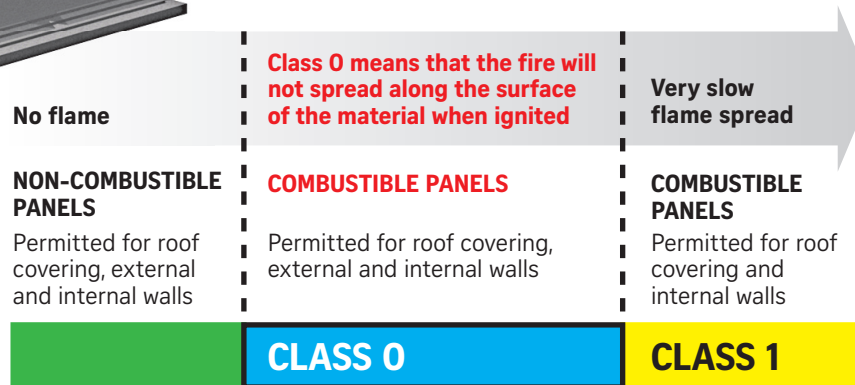

41 BUILDINGS AFFECTED

Five buildings were found to be compliant. 21 have not been tested. Those with unrestricted public access are listed here.

Buildings with non-compliant external cladding

1. 3 Pioneer Sector 3
2. 36 Jalan Tukang
3. 61 Seletar Aerospace View
4. 321 Clementi
5. CT Hub
6. JTC CleanTech Two @ CleanTech Park
7. Our Tampines Hub
8. Singapore Polytechnic (Teaching Blocks T1 to T10)
9. The Boutiq
10. The Peak @ Cairnhill I
11. The Peak @ Cairnhill II

Buildings with potentially non-compliant external cladding, which has not yet been tested by SCDF

1. 1 Changi South Lane
2. Ang Mo Kio Methodist Church
3. Connection One
4. Depot Heights Shopping Centre
5. Guoco Tower
6. JTC LaunchPad @ one-north (5 buildings)
7. Singapore Pools Building

Buildings with non-compliant external cladding that has already been removed

1. Clementi Fire Station
2. McDonald's at 60 Yishun Avenue 4
3. McDonald's at 152 Bukit Batok Street 11
4. 30 Toh Guan Road